

Project: ACE-IT
Assisting Childhood Education through Increased Testing

Effective Date: 12/11/20

Job Aid: BinaxNow™ COVID-19 Ag CARD Procedure



- Please confirm with site administrator/proctor that quality control (QC) has been performed on the lot of the box this test came from. If not, please wait until QC has been performed.

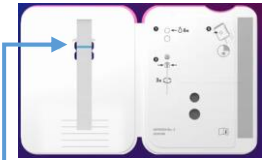

- When you first open the BinaxNow card (step #5), please check that the **blue Control Line** is present. If it is not, discard the test

and start over with a new one.

- Make sure you are both registered and familiar with the registration and results reporting app if you have any data entry responsibilities.

Collecting Anterior Nares Specimen

1. **Make sure you are wearing PPE as directed.** Perform hand hygiene and put on new gloves.
2. Gently insert swab at least 1 cm inside the nostril with more drainage, or that is

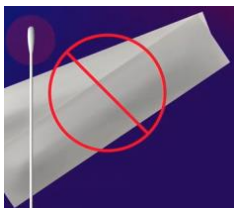

more congested.

3. Rotate swab > 5 times gently against nasal membrane for 10-15 seconds; then gently remove the swab. **Repeat with same swab in other nostril.**

4. Test swab with specimen **immediately after collection** and **do not return the**

swab to its original packaging.

Running the Test

5. Open the test card just prior to use and **lay it flat.** **Do not perform testing with the card in any other position.**



- a. Hold Extraction Reagent bottle vertically, hovering ½ inch about the **TOP HOLE.**
- b. Slowly add **6 DROPS** to the **TOP HOLE.** While putting drops on the card, **hold the swab with specimen in the other hand**, taking care not to have it touch anything.
- c. **DO NOT** touch the card with the dropper tip while dispensing.

Project: ACE-IT
Assisting Childhood Education through Increased Testing

- Insert sample into **BOTTOM HOLE** and firmly push upwards so that the swab tip is visible in the **TOP HOLE**.
- Twirl swab shaft 3 times **CLOCKWISE** (to the right). Do not remove swab.
- Peel off adhesive liner from the right edge of the test card. Close and securely seal the card and **set a timer for 15 minutes**. The card must lay flat during the entire 15 minutes of the test—not just when dropping in the reagent.

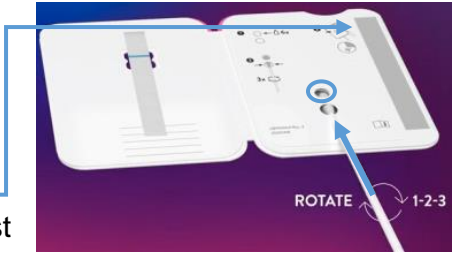

Reading the Results

- Read result in the window promptly at 15 minutes after closing the card.** Reading before 15 minutes or after 30 minutes reduces assurance of proper test performance. Note: When reading test results, tilt the card to reduce glare on the result window if necessary. Individuals with color-impaired vision may not be able to adequately interpret test results.

Negative Result: 1 pink-to-purple (or, pinkish-purple) line

Positive Result: 2 pink-to-purple (or, pinkish-purple) lines



Valid Results



No lines

Sample line only

Blue Control Line still blue after testing



Invalid Results



Invalid Results



- If result is invalid, please repeat specimen collection and test with new BinaxNow card.
- Dispose of all items used in biohazard bag provided.
- Report results as directed.